

PREPARED FOR:  
JAMES P. MARTIN S.C.  
ATTORNEY AT LAW  
547 CENTER ST.  
LAKE GENEVA, WI 53147

PLAT OF SURVEY

-OF-

UNIT 99 OF ABBEY SPRINGS

KROTT SURVEYING, INC.  
N3705 WILLOW BEND LANE  
LAKE GENEVA, WI 53147  
(262)- 248-3697

A PARCEL OF LAND LOCATED IN THE SOUTH 1/2 OF SECTION 13, T1N R16E,  
VILLAGE OF FONTANA-ON-GENEVA LAKE, WALWORTH COUNTY , WISCONSIN,  
DESCRIBED AS FOLLOWS TOWIT :

BEGINNING AT THE SOUTH-WEST CORNER OF UNIT 98 OF ABBY SPRINGS;  
THENCE S 87° 45' W 124.00 FEET; THENCE N 22° 54' E 182.36 FEET; THENCE  
S 68° 03' E 18.00 FEET; THENCE N 88° 10' E 34.00 FEET; THENCE S 0° 50' E  
157.47 FEET TO THE PLACE OF BEGINNING.



LEGEND

- ( ) = recorded as
- = found iron bar
- = found iron pipe
- = set iron pipe

SCALE 1" = 20'

JOB # 03-018UD

TAX ID # SCDB 300099

I have surveyed the above-described property and the above map is a true representation thereof and shows the size and location of the property, its exterior boundaries, the location and dimensions of all structures thereon, fences apparent easements and roadways and visible encroachments, if any.

This survey is made for the exclusive use of the present owners of the property, and also those who purchase, mortgage, or insure the title thereto within one (1) year from date hereof; and as to them I warrant the accuracy of said survey map.

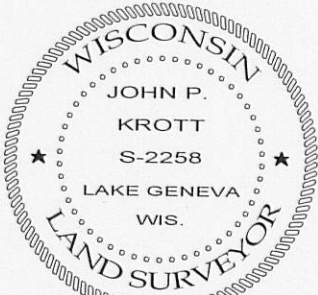
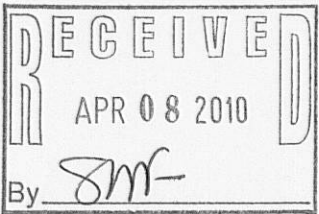

DATED THIS 28th, DAY OF JANUARY, 2010

*John P. Krott*

JOHN KROTT S - 2258  
Wisconsin Registered Land Surveyor  
( original if signed in red )